

MOSSY MEADOW

Maintenance: Removing leaves and debris that can smother the moss, moving taller grass clumps.

Tools: Soft rakes and blowers for debris removal, string trimmer.

Frequency: Once or twice a year, in autumn.

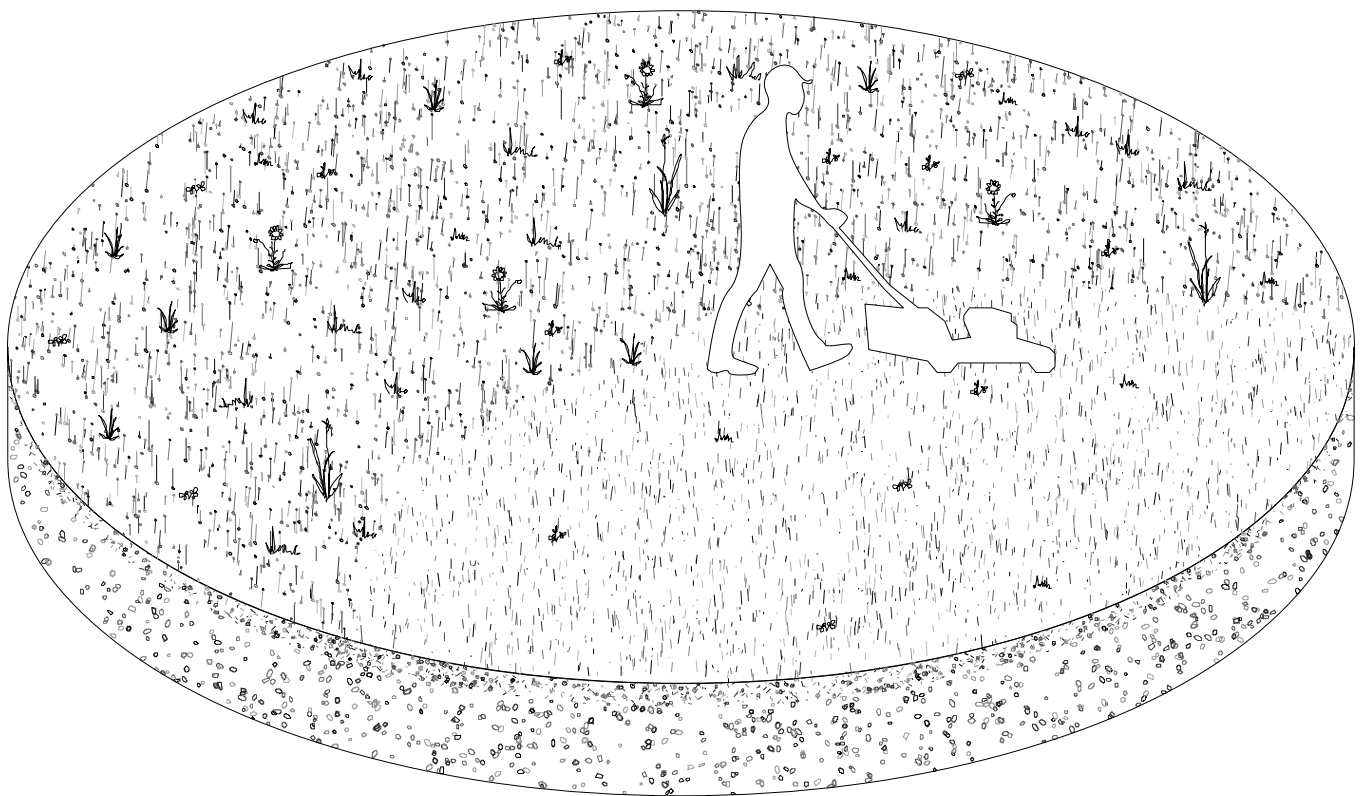

LOW MEADOW

Maintenance: Frequent mowing to maintain a lower grass height and encourage specific plant species, while keeping the area accessible to people throughout the seasons; removing invasive species.

Tools: String trimmer or push mower, rakes.

Frequency: 5-6 times per year, from late spring to late summer.

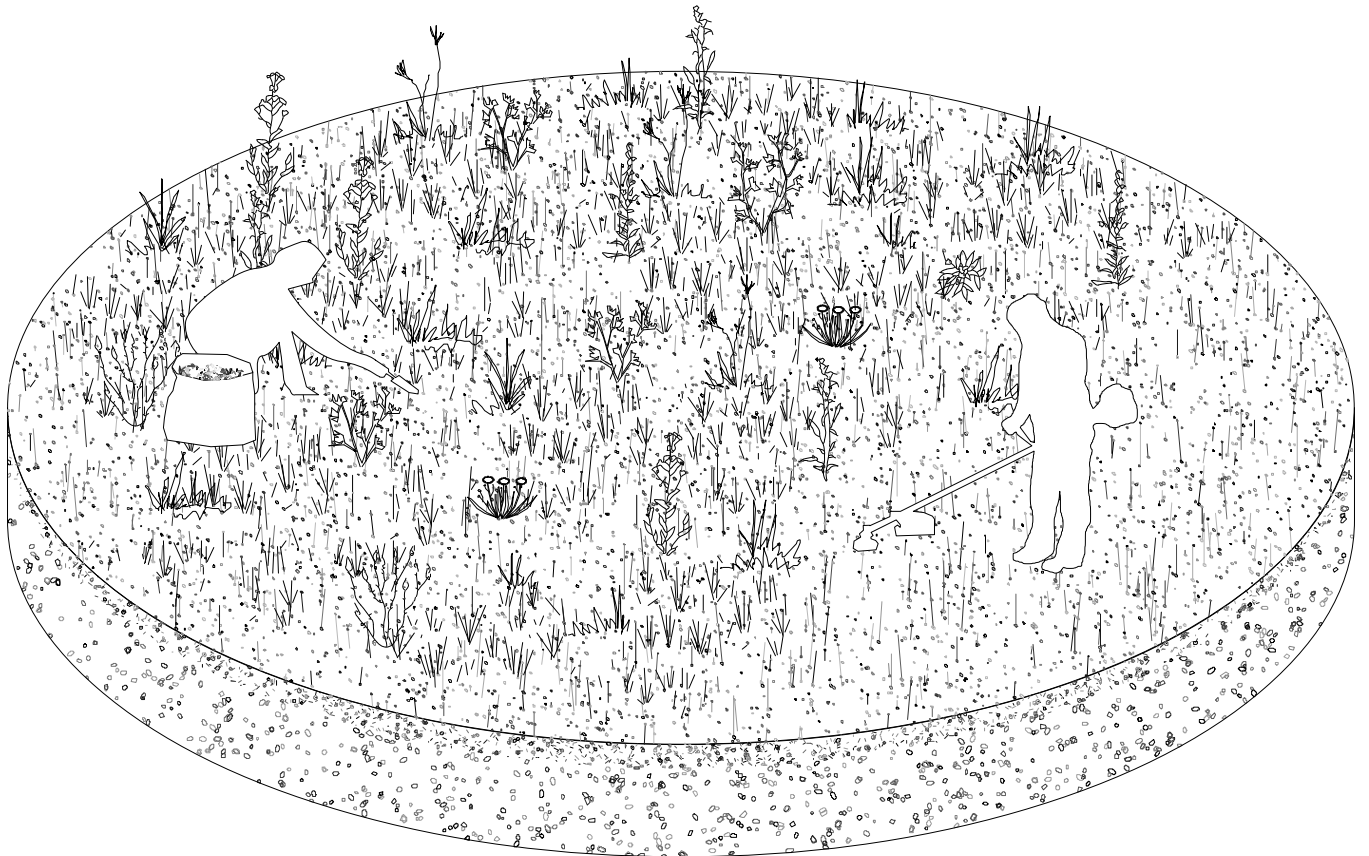

HIGH MEADOW

Maintenance: Mowing to prevent the growth of woody plants and maintain habitat for meadow species, removing invasive species.

Tools: String trimmer or tractor mower, rakes.

Frequency: Once at the end of the growing season to simulate natural grazing patterns and encourage plant diversity.

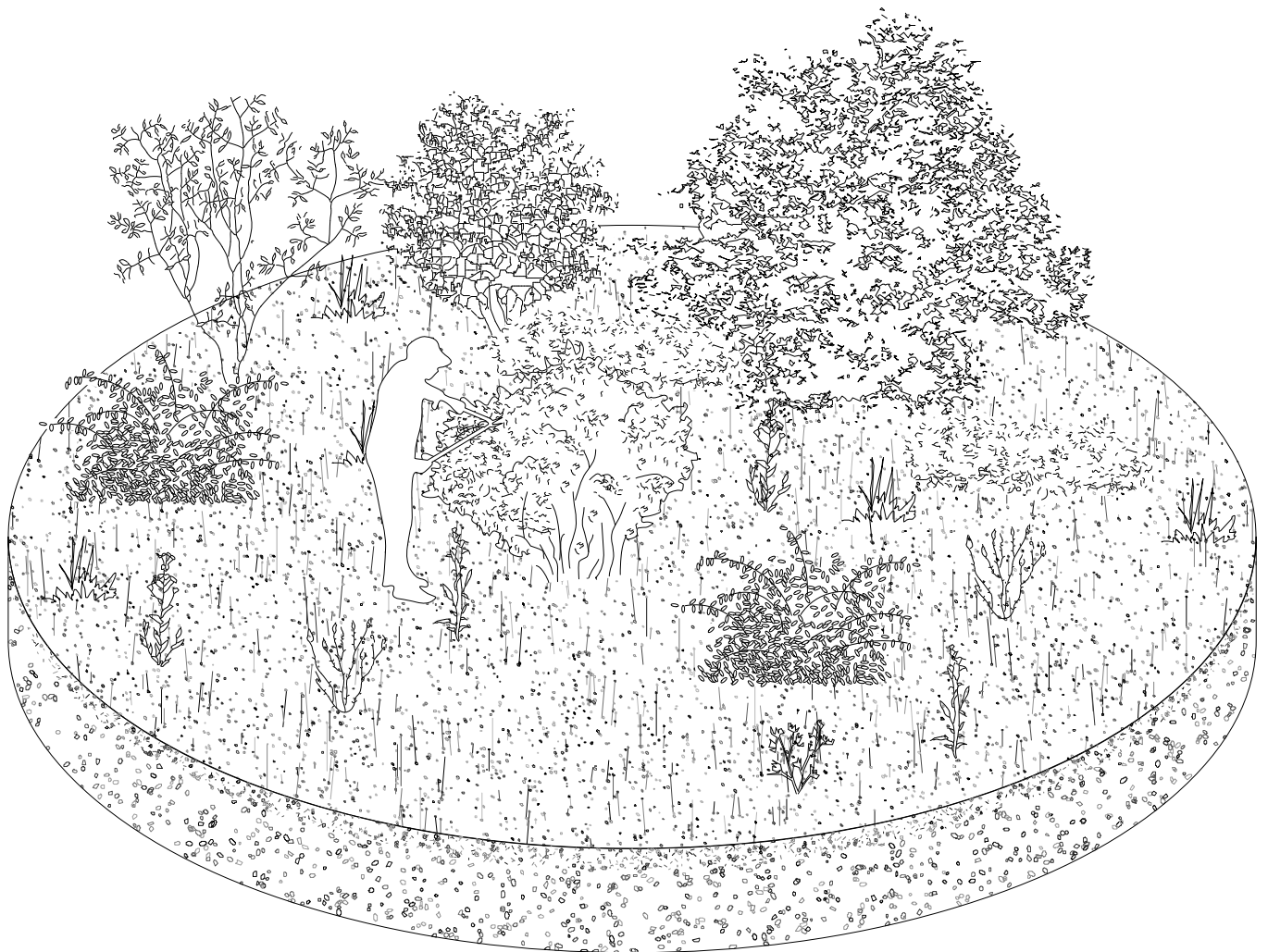

SHRUBBERY / YOUNG TREES

Maintenance: Pruning to shape the shrubs and encourage healthy growth, removing dead or diseased branches.

Tools: Hand pruners, loppers, hedge trimmers.

Frequency: Seasonal pruning twice a year, in early spring and late autumn.

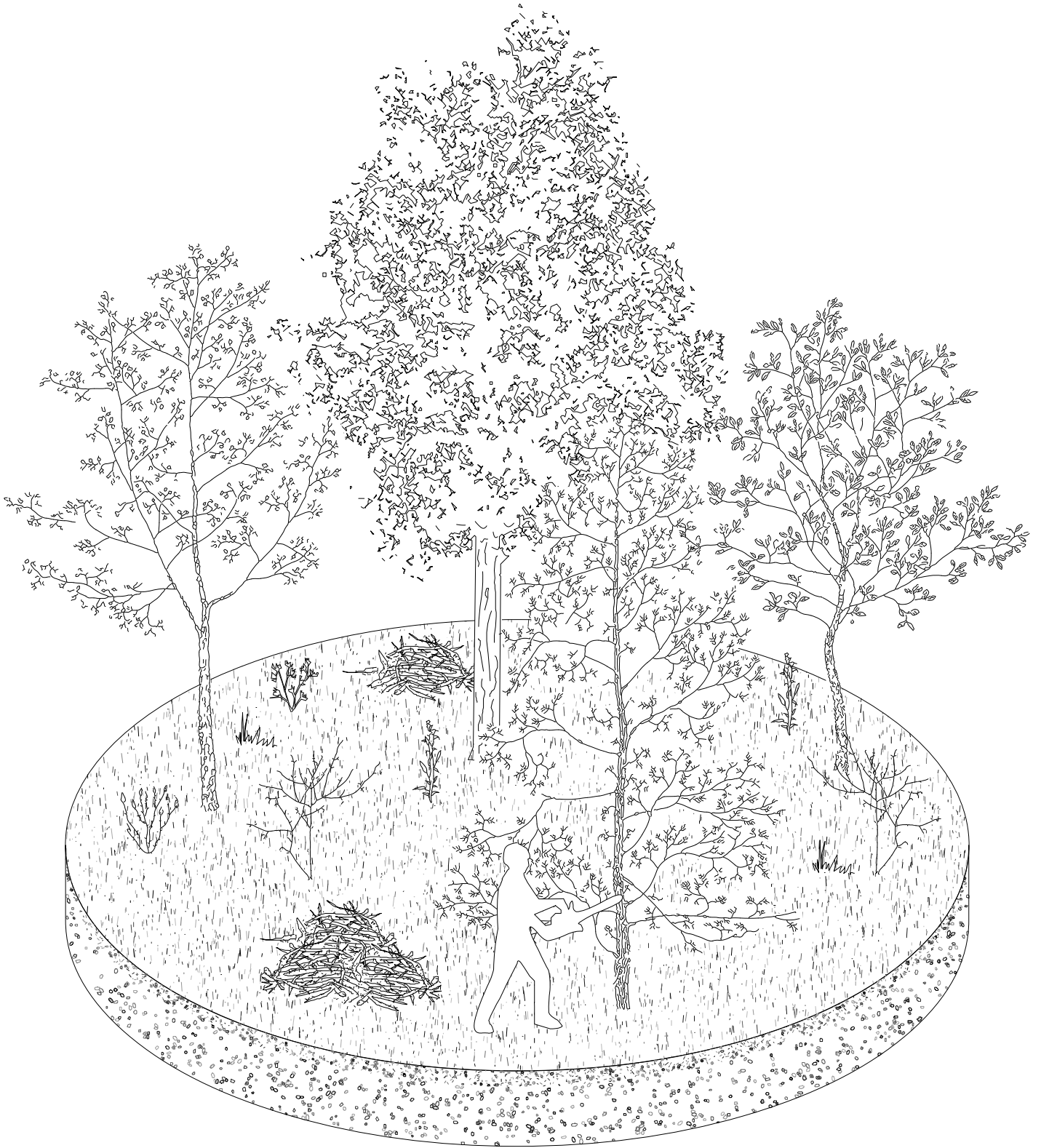

FOREST / TALL TREES

***Maintenance:** Removing invasive species, pruning to manage tree health, piling branches for animal habitats, clearing dead wood to prevent pests.*

***Tools:** Chainsaws, pruners, chipper for larger debris.*

***Frequency:** Once a year for general maintenance, with periodic checks for invasive species or disease outbreaks.*

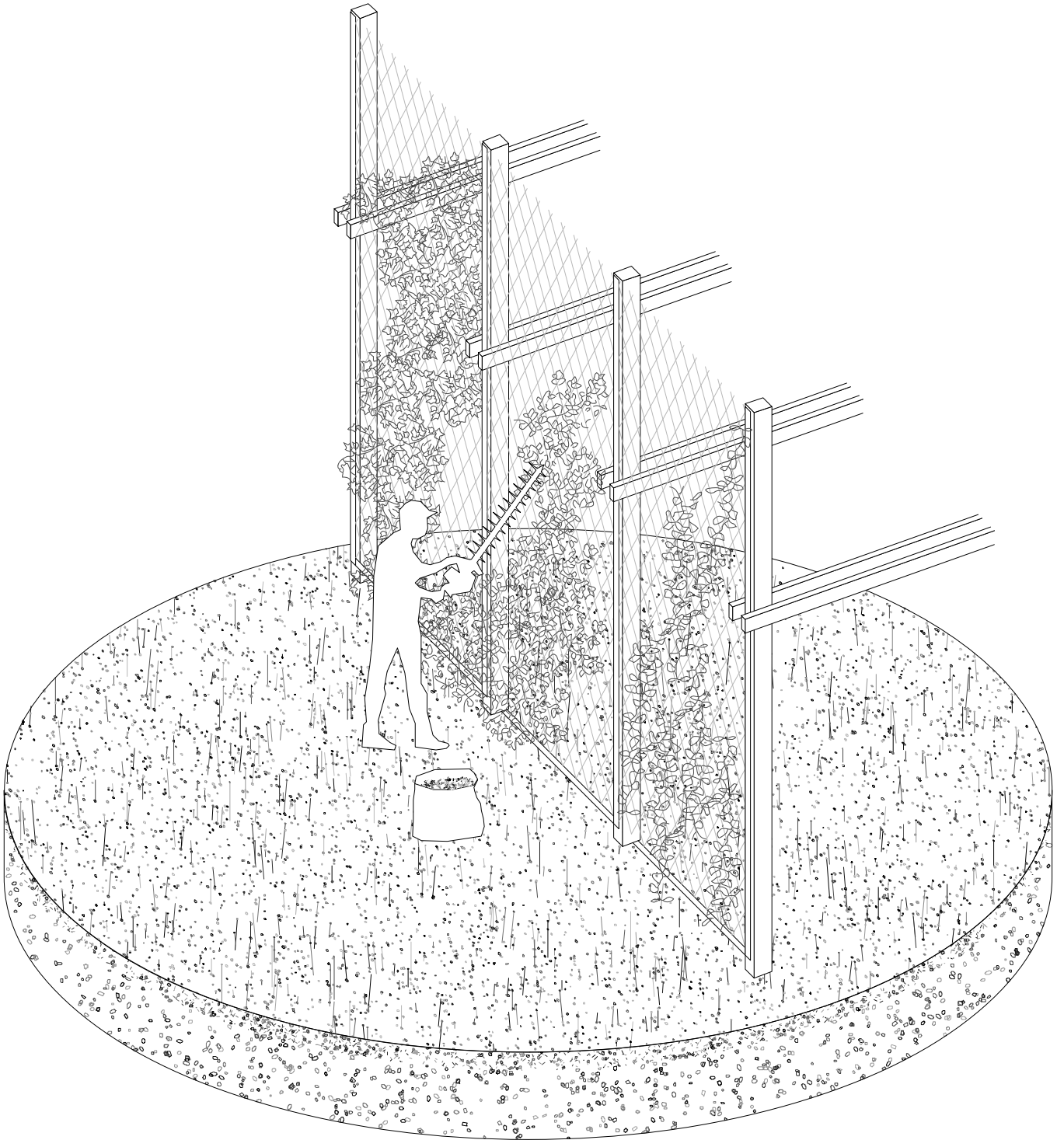

CLIMBING PLANTS

***Maintenance:** Trimming to control growth and prevent damage to the building structures, monitoring for pests and diseases, attaching to climbing structure, watering when needed through dry periods.*

***Tools:** Shears, hedge trimmers, safety harnesses for higher work.*

***Frequency:** Once a year, with frequent inspections during the growing season.*