

9/12  
 The building is structured into two parts. The archive storage forms a cubic core, following in its shape and structure rational demands of efficiency. The programs of digitisation, research and exhibition spaces surround the storage core and are structurally suspended from it. Its outer shape follows site specific parameters of construction limits, existing buildings and vegetation, and acts as a mediator between the different buildings.

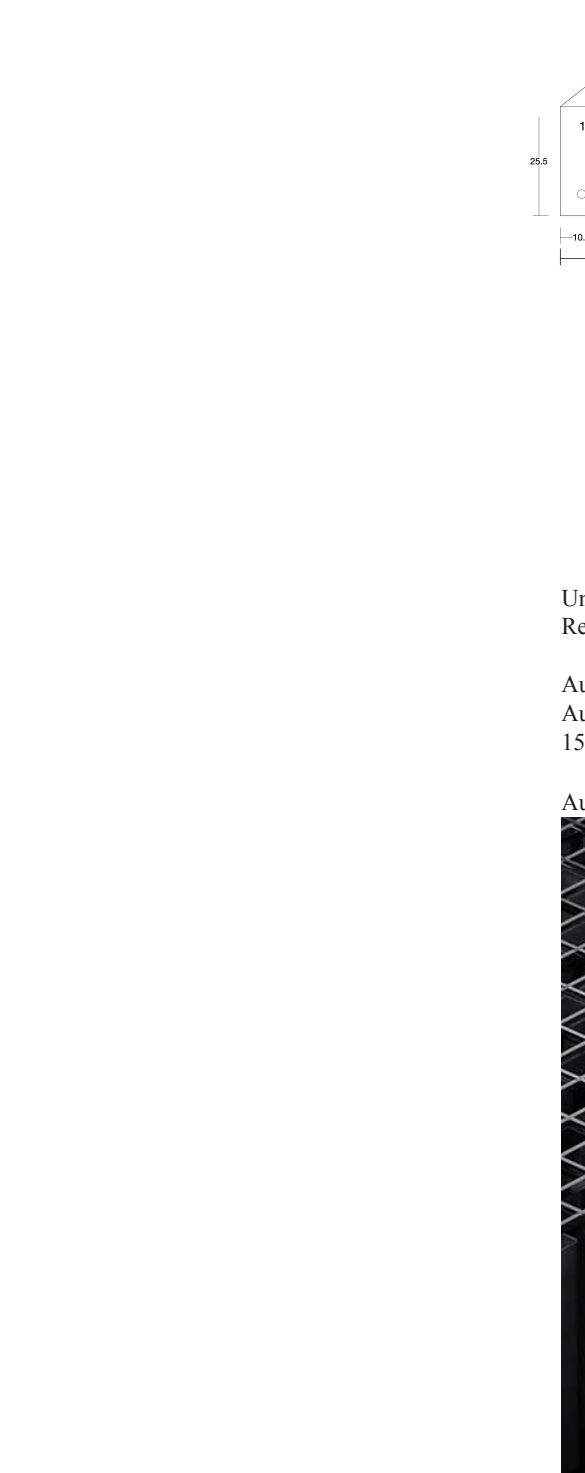

Units: 1Lkm = 1000 archive boxes  
 Required capacity: 150 Lkm/ 1.5 Mio archive boxes

Automated Warehouse System: Autostore  
 Autostore Box: 60cm x 40cm  
 150 Lkm equals 250'000 Autostore Boxes

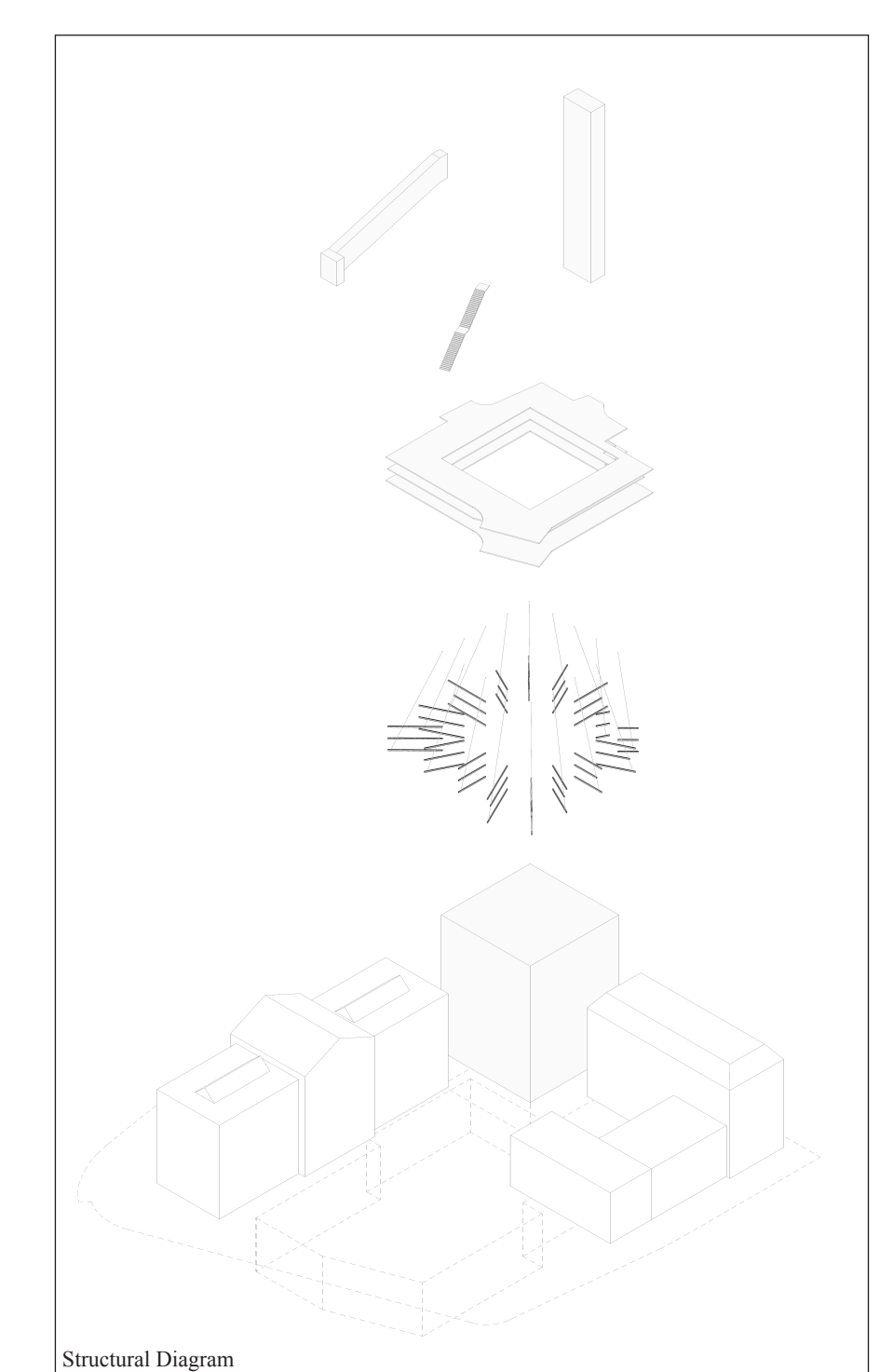
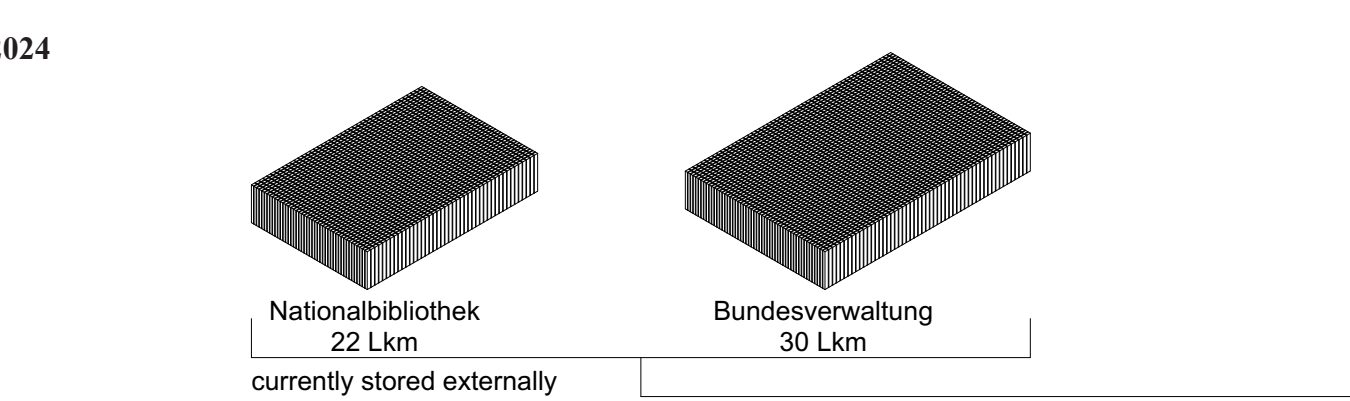
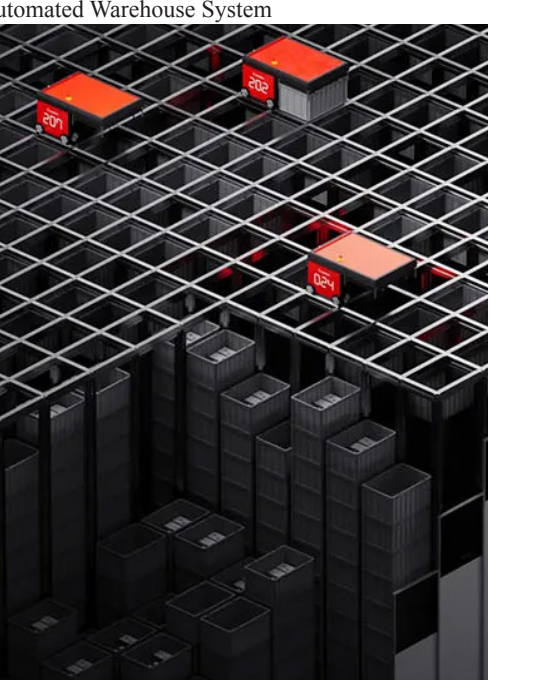

2024  
 Nationalbibliothek  
 22 Lkm  
 currently stored externally  
 Bundesverwaltung  
 30 Lkm

57 Lkm of the Federal Archives are stored in the underground facility. A further 22 Lkm are stored in the National Library's repository and by 2029, additional 30 Lkm will be added from several Federal Administrations.

10/12

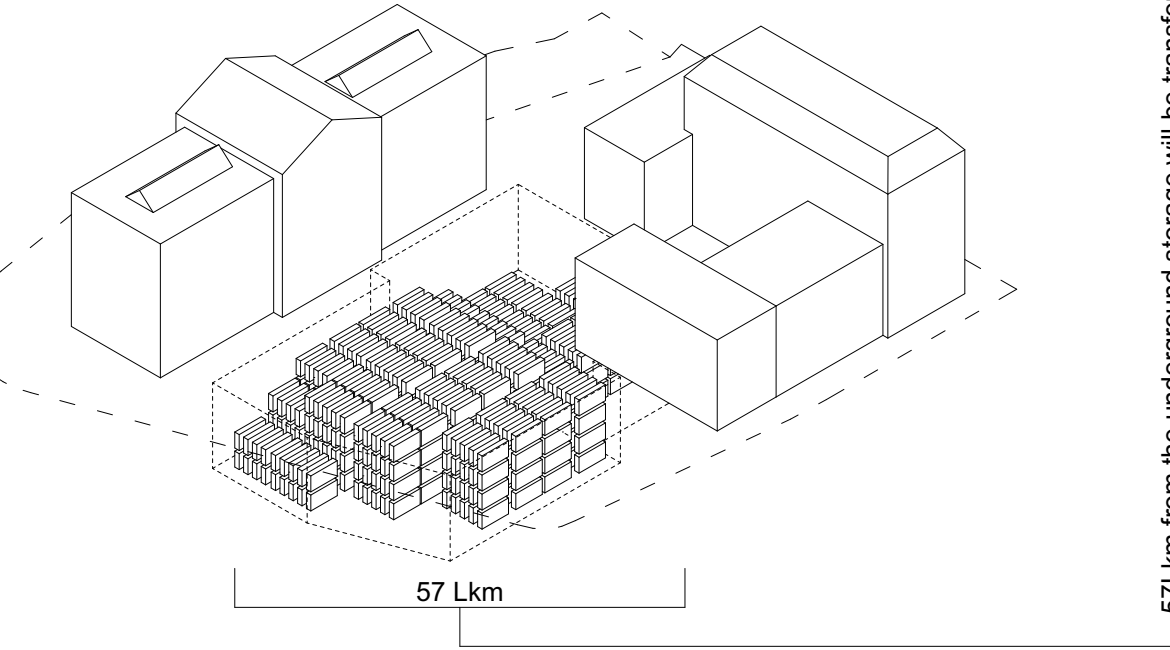

57 Lkm from the underground storage will be transferred into the new building

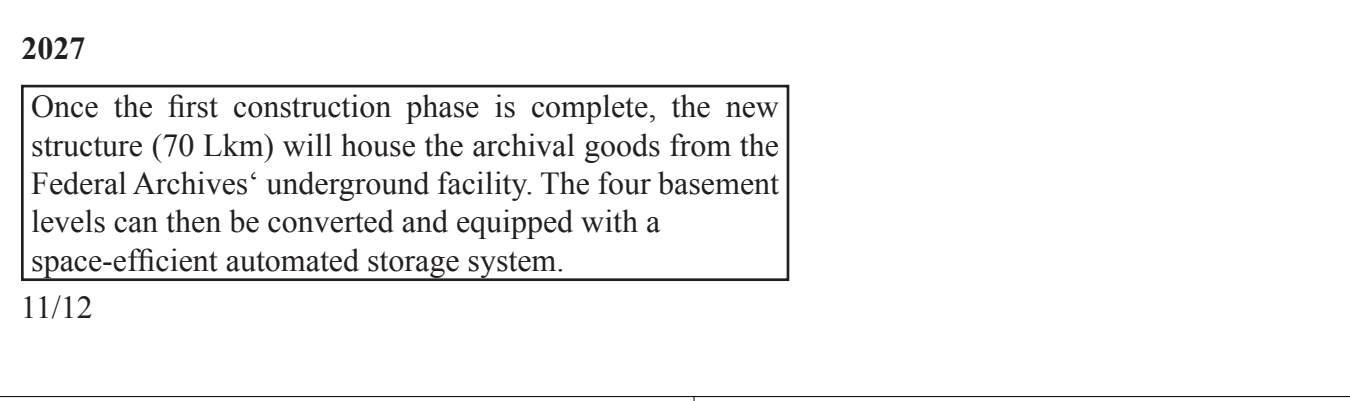

2027

Once the first construction phase is complete, the new structure (70 Lkm) will house the archival goods from the Federal Archives' underground facility. The four basement levels can then be converted and equipped with a space-efficient automated storage system.

11/12

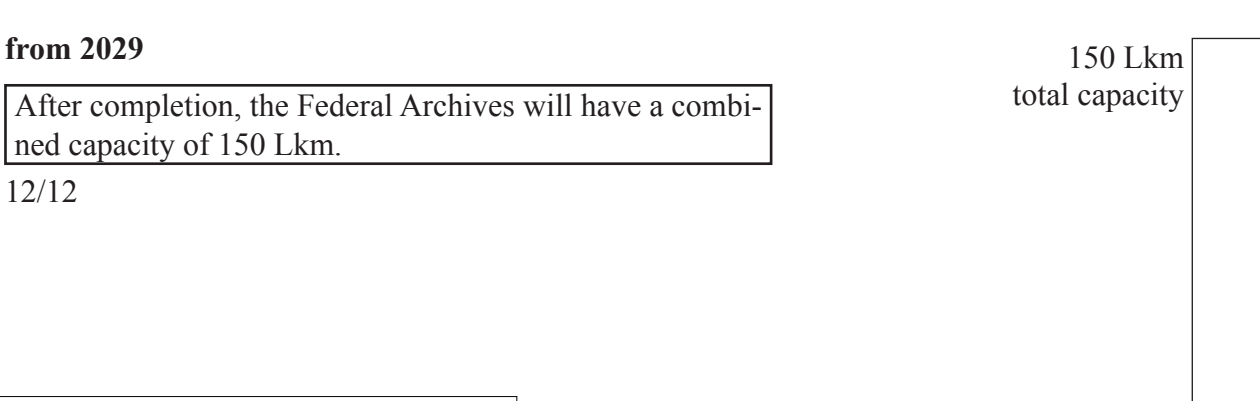
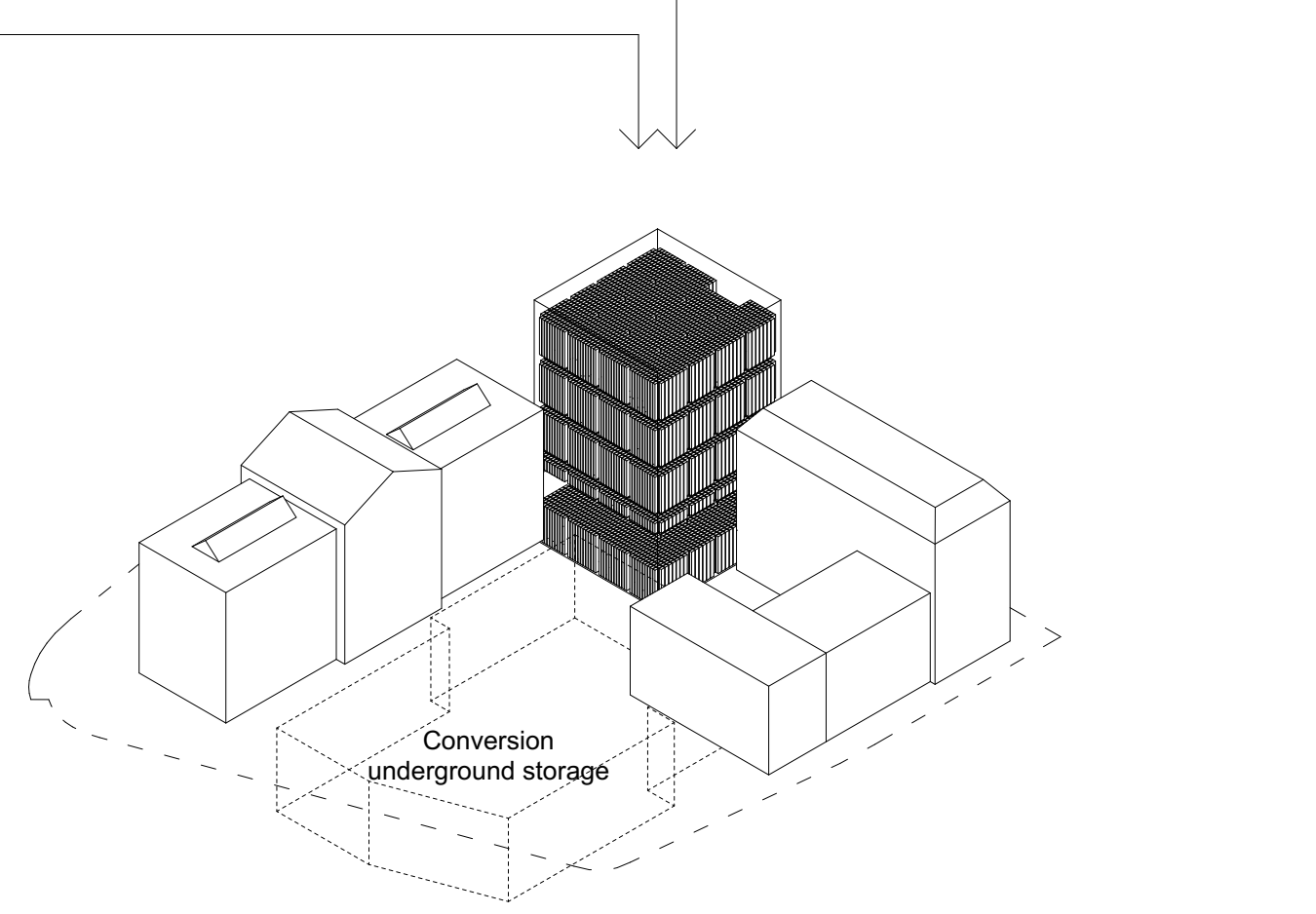

from 2029

After completion, the Federal Archives will have a combined capacity of 150 Lkm.

12/12

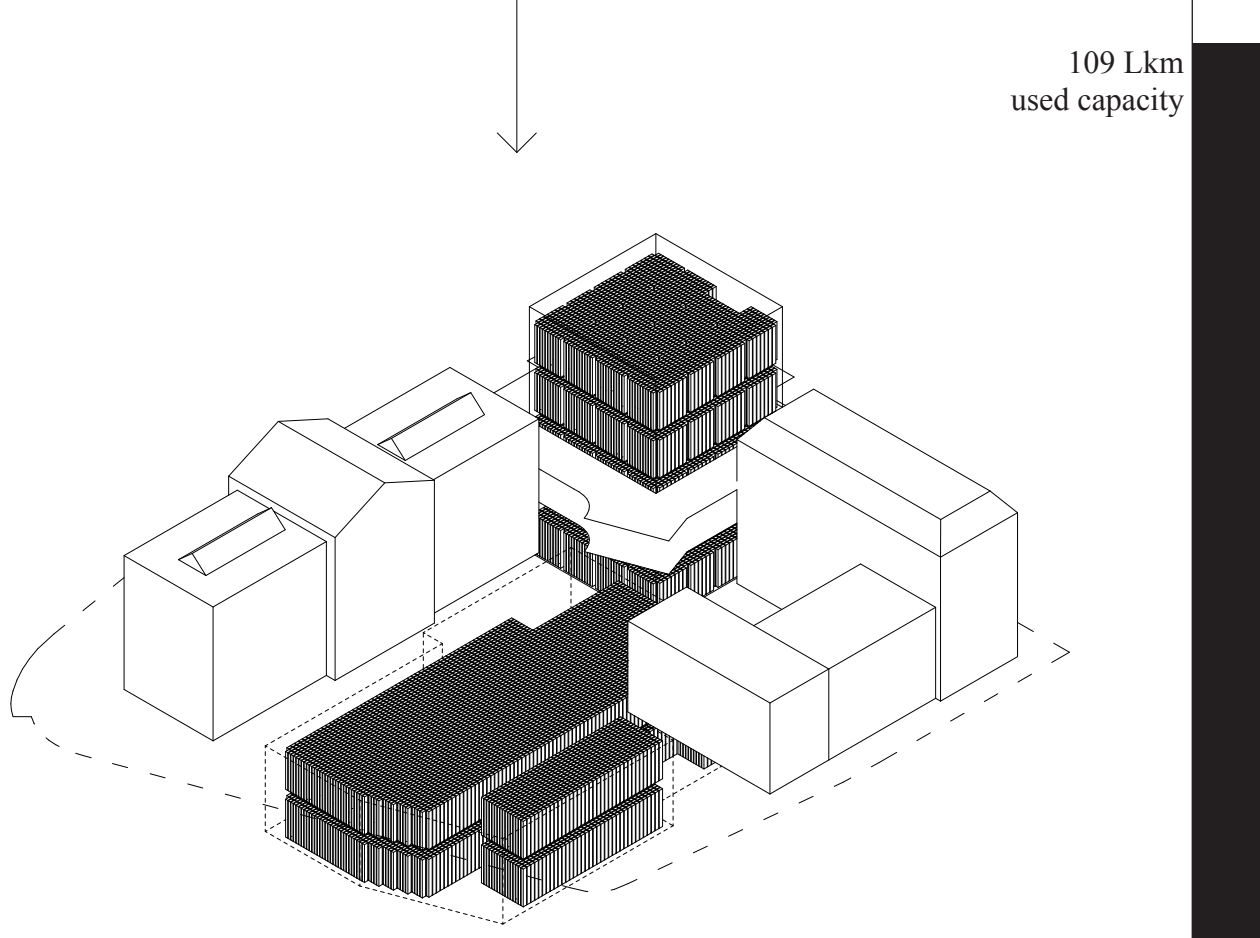

150 Lkm  
 total capacity

109 Lkm  
 used capacity